

WATERFALL NOZZLE (N.WF-SA)

Operating instructions

Contents

1. All models
2. Technical details
3. Equipment diagram
4. Install steps
5. Maintenance / Cleaning
6. Part number

1- All models of N.WF-SA

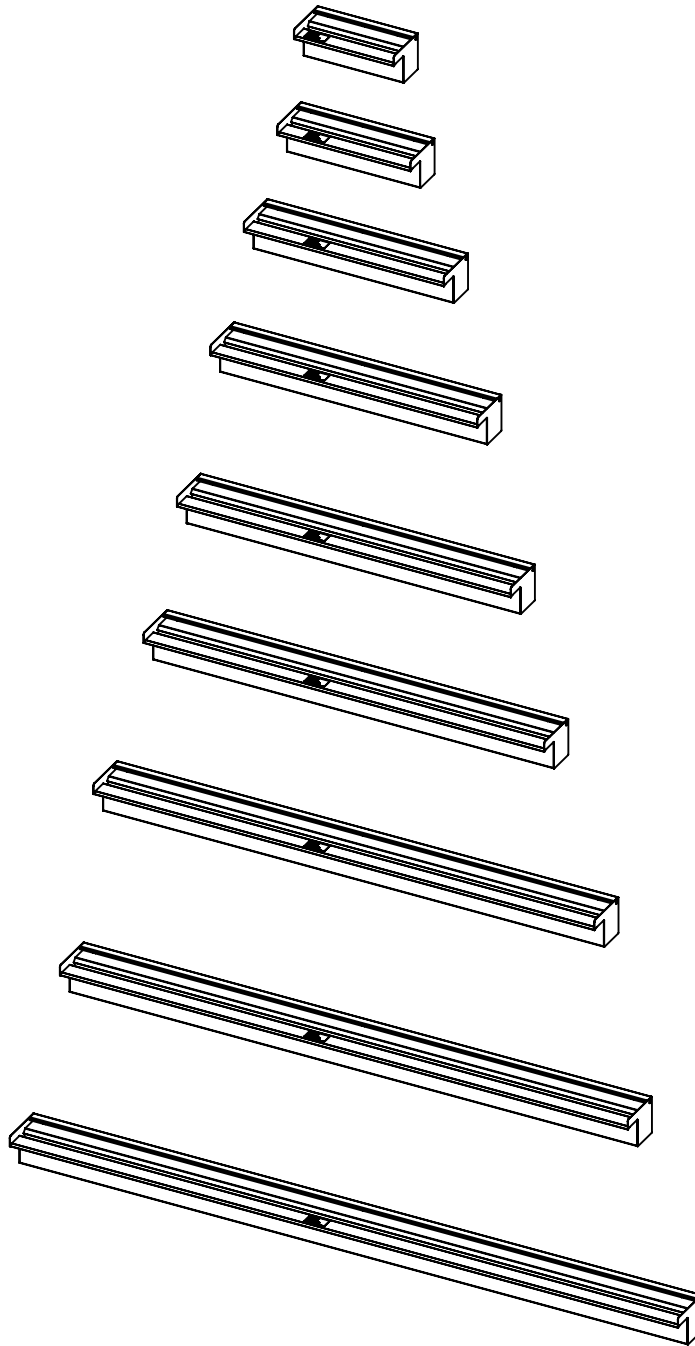

1-2 Identification Codes

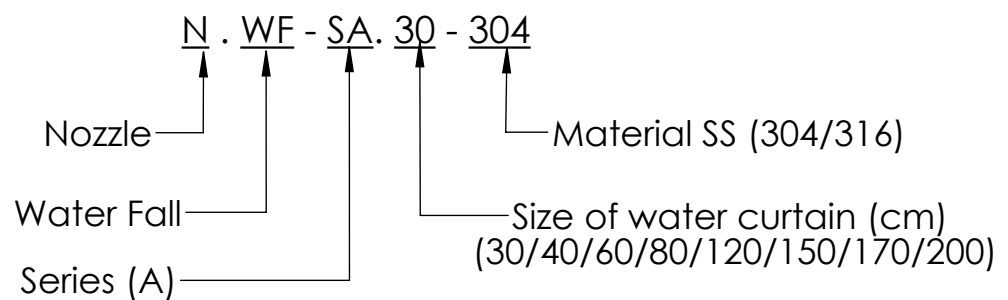

2- Technical details

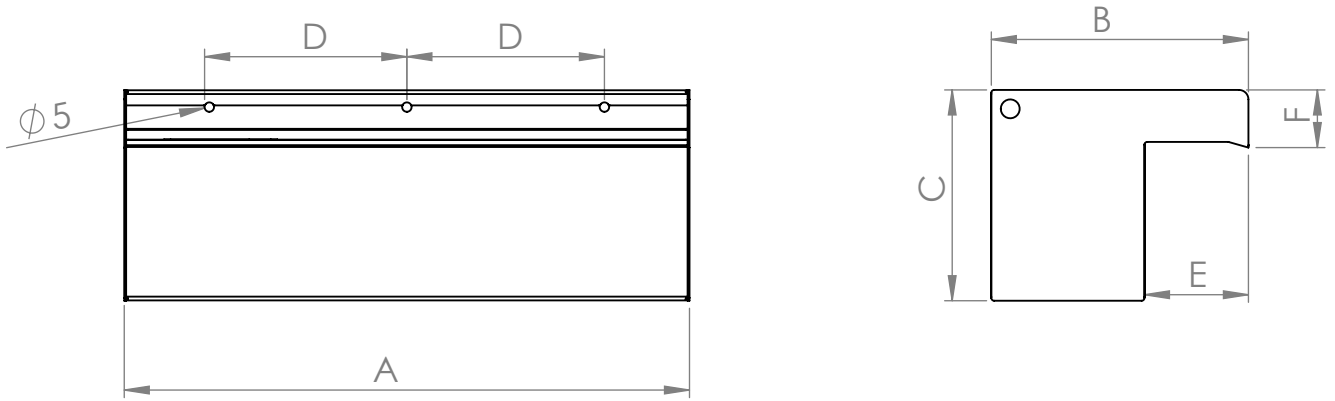

Figure 2-1

Waterfall Nozzle Series.A										
Type	WF-30	WF-40	WF-60	WF-80	WF-100	WF-120	WF-150	WF170	WF-200	
Dimensions (mm)	A	300	400	600	800	1000	1200	1480	1700	2000
	B	135								
	C	115								
	D	100+100	150+150	250+250	350+350	450+450	550+550	690+690	800+800	950+950
	E	55								
	F	35								
Details of the fountain	Height (m)	FLOW (m3/hr)								
	0.5	2.0	2.5	3.5	5.0	6.5	8.0	10	12	15
	0.75	2.5	3.0	4.5	6.0	7.8	9	13	15	19
	1.00				7.2	9.0	10	14	17	22
	1.25						11	15	19	25
Nozzle Pressure Drop (bar)	0.1									
Connection Size (Inch)	2 x G1"					4 x G1"	6 x G1"			
Water Inlets No.	1 x Back 1 x Down					2 x Back 2 x Down	3 x Back 3 x Down			
Material	Stainless Steel (304 / 316)									
Weight (kg)	2.0	2.5	3.5	4.5	5.7	6.2	8.5	9.5	11	
	N.WF-SA.30	N.WF-SA.40	N.WF-SA.60	N.WF-SA.80	N.WF-SA.100	N.WF-SA.120	N.WF-SA.150	N.WF-SA.170	N.WF-SA.200	



GSO FOUNTAIN COMPANY
www.gsofountain.com